

0020.175.008  
TWS/crd/vld  
07/13/89  
R:08/16/90

Sewer Stub Fees  
Avondale Way Sanitary  
Sewer Extension

RESOLUTION NO. 851

A RESOLUTION OF THE CITY COUNCIL OF THE CITY OF REDMOND, WASHINGTON, ESTABLISHING THE AMOUNT OF THE SEWER STUB CHARGES FOR THE AVONDALE WAY SANITARY SEWER EXTENSION.

---

WHEREAS, the City of Redmond has paid for construction of side sewer stubs to the various properties along Avondale Way through a Utility Purchase Agreement dated August 26, 1987 with Deal Enterprises, and

WHEREAS, RCW 35.92.025 and Redmond Municipal Code Section 13.11.040 authorize the City to collect from any person desiring to connect to these stubs or to develop a property for which these stubs were provided, the costs incurred by the City in constructing the stubs, and

WHEREAS, Redmond Municipal Code Section 13.11.040 states that the stub charge amount shall be established by resolution of the City Council and the City of Redmond Utility Manager has recommended stub charge amounts to the City Council for the property along Avondale Way and the City Council, after reviewing these amounts, finds the stub charge amounts are reasonable, and

WHEREAS, RCW 35.92.025 and Redmond Municipal Code Section 13.11.100 authorize the City to collect interest on the amount of each stub charge from the date of construction of the sewer improvements which serve the property until payment of the stub charge, not to exceed ten (10) years, now, therefore,

THE CITY COUNCIL OF THE CITY OF REDMOND, WASHINGTON,  
HEREBY RESOLVES AS FOLLOWS:

Section 1. Stub Charge Amount. Pursuant to RCW 35.92.025 and Redmond Municipal Code Section 13.11.040, any person who desires to connect to the City's sewer stubs within the Avondale Way Sanitary Sewer Extension, or develop a property for which a stub was provided, shall make payment to the City for the City's costs incurred in paying for the construction of the stub to the property. The sewer stub charges for the Avondale Way Sanitary Sewer Extension shall be as set forth in Exhibit A, entitled "Avondale Way Sanitary Sewer Extension Stub Fees", attached hereto and incorporated herein by this reference as if set forth in full.

Section 2. Interest Amount. Pursuant to RCW 35.92.025 and Redmond Municipal Code Section 13.11.100, the City shall collect interest, at the annual rate of 7.25%, on the amount of each stub charge from the date of construction of the sewer improvement which serves the property served by the water and sewer stub connection until such stub charge is paid. This interest charge shall not accrue for more than ten (10) years.

Section 3. Assessment of Charge - Time. Applications for connection to the water and sewer systems shall be made to the City of Redmond Public Works Department on a printed form furnished for that purpose, and the Public Works Department shall calculate the applicable stub connection charges, including interest, at that time.

RESOLVED this 20th day of November, 1990.

APPROVED:

*Doreen Marchione*  
MAYOR, DOREEN MARCHIONE

ATTEST/AUTHENTICATED:

*Doris A. Schaible*  
CITY CLERK, DORIS A. SCHAIBLE

FILED WITH THE CITY CLERK: 11-15-90  
PASSED BY THE CITY COUNCIL: 11-20-90  
RESOLUTION NO. 851

**EXHIBIT A**  
**AVONDALE WAY SANITARY SEWER EXTENSION**  
**STUB FEES**

TAX LOT	STUB	STUB FEE
46	1-6" Stub	7,336.20
154	1-8" Stub	7,336.20
152	1-6" Stub	7,336.30
42	1-6" Stub	7,336.20
51	1-6" Stub	7,336.20
2151	2-6" Stubs	14,672.40
30	1-6" Stub	7,336.20
15	1-6" Stub	7,336.20
22	1-8" Stub	7,336.20
<b>10 STUBS</b>		<b>TOTAL 73,362.00</b>

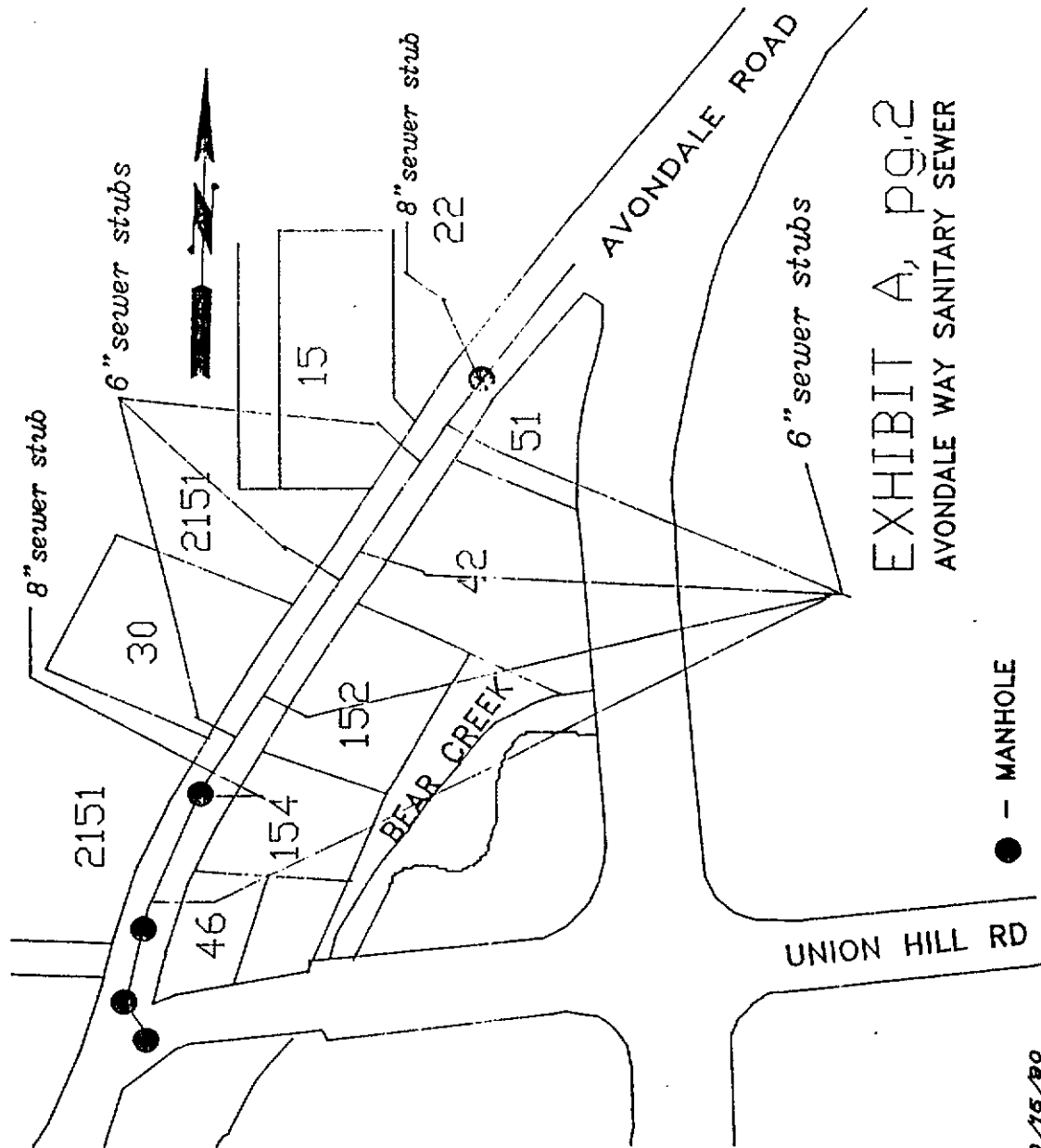

10/15/90  
AVONEX7